

www.hueppe.com

**MODEL**

X1

**REF. NO.**

2-WAY 1000 PANEL 1000

**DESCRIPTION**

2-Way door 6 mm reversible  
1000 x 1900 mm  
+ side panel 4 mm  
reversible 1000 x 1900 mm

**GLASS TYPE**

Clear Tempered

**PROFILE COLOR**

High-gloss Silver

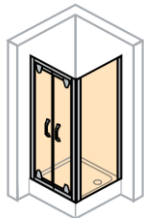

Installation :  
two way door  
+ side panel



Door handle



Glass pivot hinge

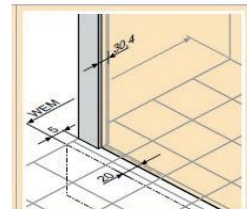

Floor-flush installation  
- scenario 001  
WEM = Tray installation dim.

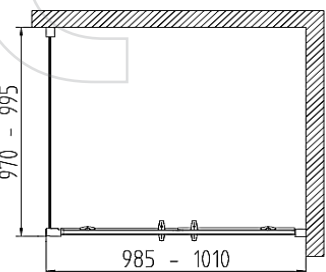
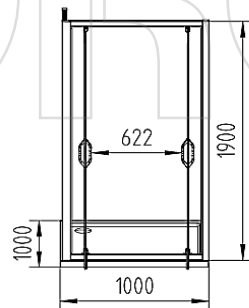
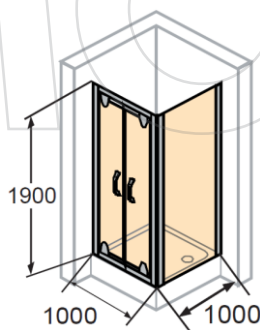

Adjustment range for compensating uneven walls : -15/+10 mm (for in recess Total -30/+20 mm)  
Setback : 5 mm for side panel